

Capability Statement



Delivery | High Quality | Strong Relationships

www.cablewise.com.au (08) 9249 9299



The Company

Cablewise Electrical and Communications Pty Ltd was incorporated in January 2003. Initially carrying out minor fit-outs and maintenance work, the business gradually began to undertake larger-scale projects and has evolved into the company it is today. Cablewise directors are actively engaged in the business. We believe this direct involvement results in better service delivery for our customers and provides positive leadership for our employees.



Cablewise is an industry leading provider of electrical and communications solutions.

With a strong focus on relationships, we partner with manufacturers in the electrical and communications industry including Schneider Electric, Clipsal as EcoXpert Partners, Commscope (Netconnect, Systimax), Panduit, APC and Molex.

Our experience base comprises:

- › Hospital and medical installations
- › Education facilities
- › Defence
- › Data centres
- › Commercial fit-outs
- › Hospitality
- › Industrial installations
- › Integrated services
- › Preventative maintenance

“

At Cablewise, we recognise our relationships are not top down. Every person in our business is striving for our customers' success.

Daniel Schneider—Director

”

The Cablewise Team

Leaders in Electrical & Communications Solutions

The Cablewise directors are actively involved in business development, operations and the delivery of our services. There is a strong governance framework in place. As a management team we consistently review our strategy and there is a strong culture of accountability and execution. Good governance is central to what we do.

The Cablewise Board



Daniel Schneider	Managing Director		
Stevie Watson	Executive Director		
Trent Petersen	Executive Director		
Andrew Birch	Advisory Board Member	Steve Ainscoe	Shareholder
Brent Black	Advisory Board Member	James Warrener	Shareholder

Management Structure



Daniel Schneider Managing Director	Trent Petersen Executive Director	Stevie Watson Project Manager	James Warrener Project Manager	Steve Ainscoe Project Manager	Brett Kelly Estimator	Mason Curini Account Manager	Dave Truman CIS Manager
--	---	---	--	---	---------------------------------	--	-----------------------------------

Please find us on LinkedIn

<https://www.linkedin.com/company/cablewise-electrical-and-communications-pty-ltd>

The Cablewise Way

“ Our core values are paramount to our success.
We strive to live by our values every day. ”

Daniel Schneider—Director

Our people are Cablewise. Their safety, wellbeing and development is of utmost importance.

Cablewise is invested in the engagement of its employees.

We believe this will foster organic growth, long-term employee retention and make for an enjoyable place to work. This approach will naturally have a positive effect on our customers and the delivery of our services. Some of the successful programs we employ include:

› **Employee recognition program**

“We recognise and encourage the efforts of our employees”

› **Mentoring Program**

“Everyone has an effective mentor”

› **Culture statement**

“We take a long-term view in decision making”

› **Training and Development**

“Every employee has an individual training and development plan that is tailored to their specific needs and preferred path to success”

COMPANY VALUES

Safety - Safety of our people, and those around us, is second to none

People - Our people are Cablewise. Their safety, wellbeing and development is of utmost importance

Relationships - We value our relationships with our people, customers and suppliers. We act with integrity

Quality - Consistently completing projects at a high quality, with strict control measures

Reliability - Our customers will know to expect a professional service

CULTURE ATTRIBUTES

› We take a long-term view in our decision making

› Relationships are based on mutual success

› Everyone sweeps

› We are all responsible for our culture

› We deliver on our core values

Safety Performance

“

Our actions are what defines our safety performance.

”

Stevie Watson -
Director

Safety of our people and those around us is second to none.

We are a safety-focused company. The wellbeing of our people and those around us is embedded in our culture.

We consistently audit, review and execute our safety systems. All Cablewise employees are provided with relevant and specific to the task PPE. Cablewise provides complete, clear and concise site-specific SWMS or JSAs, all utilising the risk matrix format as well as the hierarchy of controls to identify risk rankings based on the likelihood and consequence of stated events. Some of the following internal safety systems we undertake include:

› **Isolation Procedure**

Electrical safety is paramount, we take the strongest approach working on electrical services to ensure the risk is eliminated to our employees and others.

› **Energisation Toolbox**

Energisation of installations can carry risk when there are a significant number of trades and contractors involved. We make it a priority to ensure that all people on site are aware of the electrical risks prior to the commissioning and energisation of an electrical installation.

› **Toolbox Talks**

Toolbox talks are regularly conducted each month on mobilised sites, covering relevant safety updates and regulatory industry changes.

› **Site Safety Audit Procedure**

A strong safety culture requires accountability and execution of procedures. Our audit process is conducted on all active job sites, measuring the effectiveness of our safety procedures and ensuring they are followed by all employees and management teams.

Cablewise Safety Committee

The Cablewise Safety Committee consists of the Business Manager and lead electricians who meet regularly to discuss and review procedures so they are relevant to our everyday operations.

Reflecting on any industry changes or governing body instructions, the Cablewise Safety Committee ensures the information and actions arising from these important meetings are effectively communicated to all Cablewise employees.

The Cablewise Safety Committee continues to develop and implement the existing safety procedures, whilst striving to ensure all required elements of safety within our industry are captured, with the long-term goal of AS4801 accreditation.



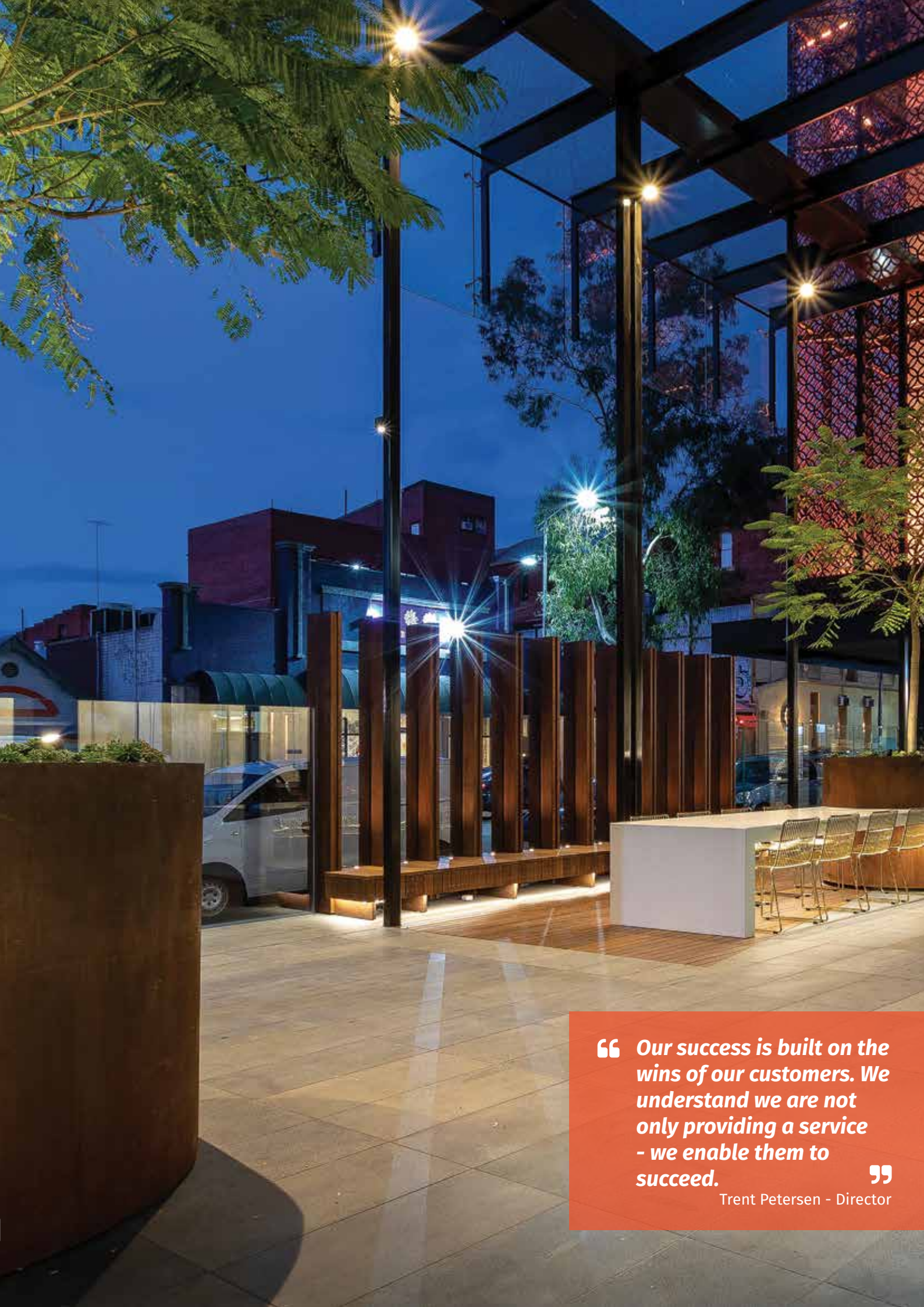

“ Our success is built on the wins of our customers. We understand we are not only providing a service - we enable them to succeed. ”

Trent Petersen - Director

Communications Services

Leaders in communications infrastructure design, implementation and installation.

Our team includes multi vendor registered and certified communications distribution designers, certified data centre designers, manufacturer certified installers, and we are long-standing supporters of industry groups including BICSI.

From design, project planning, installation, commissioning and certification, our accredited team can provide end-to-end solutions for all telecommunications projects

Capabilities:

- › Multi vendor fibre optic installation, testing and commissioning
- › Multi vendor copper structured cabling design and installation
- › BAS—Building Automation Systems
- › MATV

Business Partner Vendors and Accreditations:

- › Commscope
 - Systimax
 - Netconnect
- › Panduit
- › Molex
- › Schneider Electric
- › Siemon



Electrical Services

Cablewise has broad experience in the delivery of electrical services.

With a reputation for quality, detail and a safety first approach, Cablewise is an industry leading company of electrical professionals. Some of the electrical services provide include:

- › **Commercial electrical design and installations**
- › **Industrial electrical design and installations**
- › **Generator installations**
- › **UPS installations**
- › **Critical defence infrastructure installations**
- › **Installations within sensitive and secure electrical environments**
- › **Distribution board installation using local manufacturers**
- › **Body protected and Cardiac protected medical installation**



Cablewise Integrated Services - [CIS]

Cablewise Integrated Services understands the dynamic and constantly changing landscape of building automation. With multi vendor design capability, CIS delivers a professional and reliable service.

CIS specialises in advancements on controls systems, including lighting control, BMS integration and energy management. Customer and delivery focused, CIS is a business partner with Schneider Electric (EcoXpert Partner), Philips Dynalite and KNX.

CIS can design, program and install a tailored solution to meet any project requirements with the support of its premier business partners. With the progression of NABERS and Green Star ratings, building owners and operators will find a valuable partner in CIS with its vast experience in the development and delivery of energy management reporting and energy conservation solutions.



Business Partners:

- › Schneider Electric
 - C-BUS
- › Philips Dynalite
- › KNX
- › DALI
- › SOMFY
- › Clevertronics
 - Clevertest
 - Zoneworks

William Square Rejuvenation

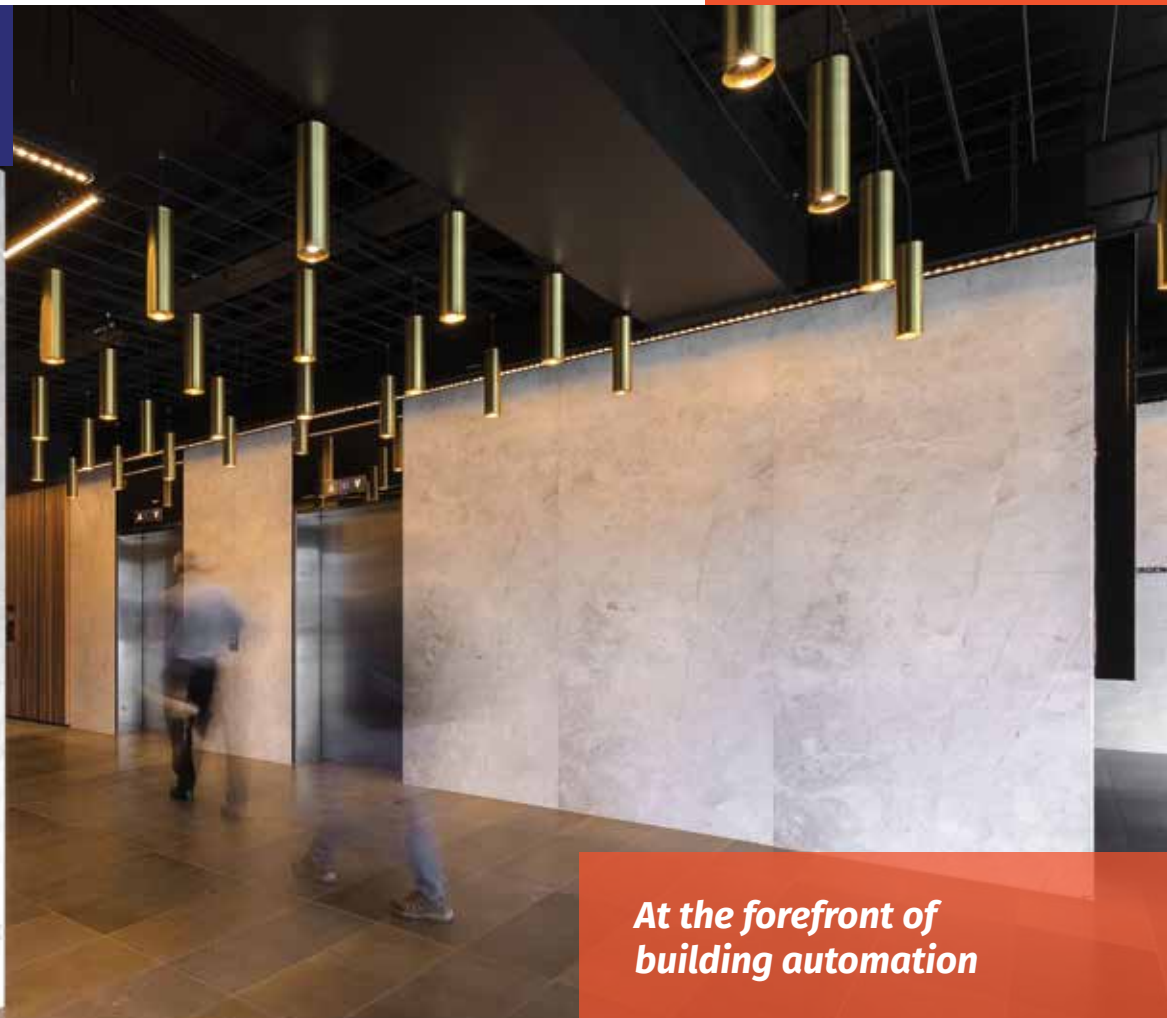

At the forefront of building automation

“



“

The Carcione Group of Companies (owners of 1120 Hay Street, West Perth and 629 Murray St West Perth) have engaged Cablewise Electrical & Communications Pty Ltd as the incumbent Electrical and Communications contractor for the last 10 years.

During this time, Cablewise have continuously provided efficient and reliable service, cost effective solutions and ongoing advice relating to the optimal operation of the building electrical and data services .

The Carcione Group of Companies are committed to safety and quality; Cablewise have always complied with all required inductions, processes and procedures.

Vince Carcione - Director

Clientele:

- › Charter Hall
- › Knight Frank
- › CBRE
- › Schlumberger Australia
- › WAPOL
- › The Perth Mint
- › Department of Commerce
- › Technip Oceania
- › Iluka
- › Metropolitan Redevelopment Authority
- › Department of Treasury and Finance
- › Warrington Property

Service And Preventative Maintenance

Cablewise understands the needs of our clients and as a result we aim to provide a responsive and comprehensive service to deliver on our customers expectations.

Cablewise can provide a variety of preventative maintenance and servicing including:

- › Emergency and exit lighting maintenance.
- › RCD testing and replacements.
- › Thermographic testing and repairs.
- › General lighting maintenance including commercial tenancies, carpark lighting, warehouse lighting and street lighting.
- › Communications and telephony fault finding and repairs.
- › Small-to-medium office and warehouse refurbishments consisting of electrical, communications and lighting installation.

Case Study

Technip FMC and Dice Renascent

Technip FMC Perth Head Office Fit-out
Ground Floor, Level 1, Level 2, Level 3, Level 16 & Level 17



Year



Under \$2M



6000 SQM

Detail of Works Completed under Contract or Agreement:

COMMERCIAL FACTORS

- › As Technip FMC's long-standing and valued incumbent, Cablewise were single select for the electrical and communications scope of works for the complete Fit-out
- › A strong focus on OH&S policy and execution with Renascent, fostered a safe working environment and lead to the delivery of the project with zero LTI's
- › Partnerships with the likes of Commscope(Systimax) & SchneiderAPC formed our capable and reliable supplier network to support the delivery of the project on time and budget
- › A dynamic projects team was necessary to deliver the changing circumstances of the TechnipFMC business. A company re-structure of TechnipFMC required complex, multiple scope changes at different stages of the program, of which Cablewise could support and provide whilst adhering to the original construction program and mitigating delays to the TechnipFMC head office relocation.
- › Consistent engagement and communication with the consultancy team at Alphazeta was imperative to ensure the successful delivery of the project

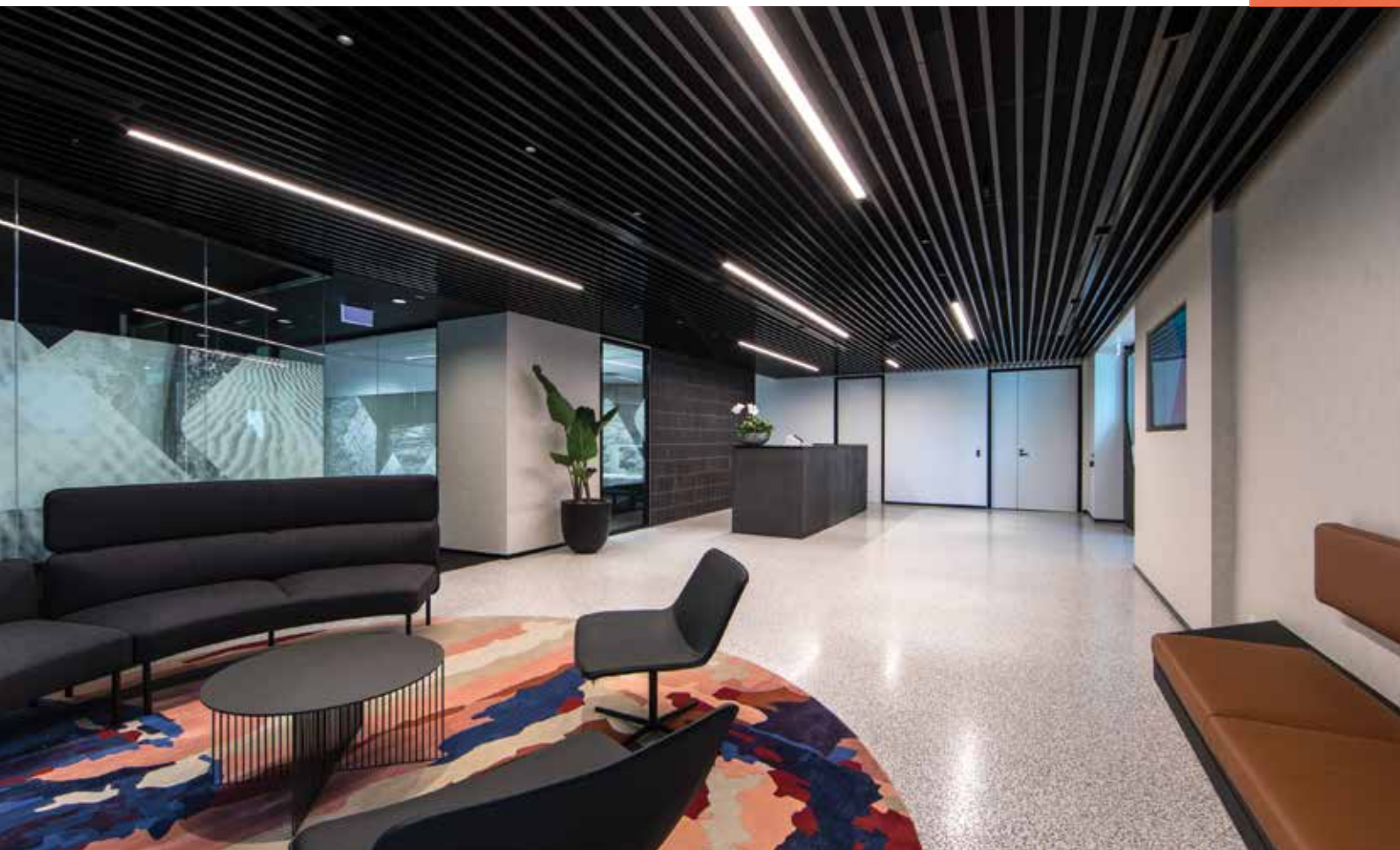



“ ***This project was challenging, with tight deadlines and many changes due to our business restructure. Cablewise understood our requirements, core value of safety first, and environmental objectives.***

They were proactive to assist us quickly with changes, and accurately, assessed our needs to offer the best solutions to the issues at hand.

They worked well with the other service providers working on the project and always communicated effectively.

The project was completed on time and under budget. We are extremely happy with their service and would highly recommend their services.

Joy Hearle - Building & Facilities Lead

TECHNICAL SERVICES

- Provision of a Commscope Systimax Category 6 & 6A structured cabling solution
- Western Australia's first deployment of Systimax OM5 multi-mode fibre, consisting of multi-level MPO-MPO vertical and horizontal solution
- Installation of an APC Symettra UPS and APC Netshelter SX series server racks to each floor communications room. Deployment of APC Netbotz EMS including the integration of emergency server room shut-down and fire detection systems
- Comprehensive APC Netbotz EMS integration with mechanical services and fire detection systems
- Dyalite Dali Intelligent lighting control including Crestron Audio Visual, emergency and exit lighting integration and blind control integration- completed by the team at Cablewise Integrated Services.
- Detailed feature lighting installed within bespoke ceilings and finishes

Case Study

Renasant

Clifford Chance Office Fit-out
Ground Floor, 235 St Georges Terrace



Year



Under \$1M



900 SQM

Detail of Works Completed under Contract or Agreement:

COMMERCIAL FACTORS

- Clifford Chance are one of the world's pre-eminent law firms, with significant depth and range of resources across five continents.
- A strong focus on OH&S policy and execution with Renasant, fostered a safe working environment and lead to the delivery of the project with zero LTI's.
- Partnerships with the likes of Siemon formed the ability to provide a communications cabling system with the best PVC practices included.
- Cablewise was uniquely positioned to support and complete the electrical, communications and intelligent lighting installation for their new office..
- A short construction program required consistent and effective communication with all stakeholders to meet project deliverables





“ *Cablewise completed Clifford Chance’s objectives including assisting in the relocation of active equipment from their existing premises to facilitate Business operation prior to the relocation of Clifford Chance Staff.* ”

James Warrener - Project Manager

TECHNICAL SERVICES

- › Provision of a Siemon Category 6 & 6A structured cabling solution
- › Installation of an APC UPS paying critical attention to Clifford Chance IT and Business Team to ensure a smooth transition of their existing system.
- › Comprehensive APC Communications Room Equipment package inclusive of server racks
- › Dyalite Dali Intelligent lighting control Dyalite lighting solution including integration of AV, Blinds and Temperature Monitoring
- › Detailed Modular feature lighting installed within bespoke ceilings and finishes

Case Study

Shape Group

Department of Communities Office Fit-out
130 Stirling Street, Perth



Year



Under \$1.5M



4000 SQM

Detail of Works Completed under Contract or Agreement:

COMMERCIAL FACTORS

- › High-end, sustainable office fit-out in Perth complete with EV chargers
- › Cablewise Electrical recently delivered a 3-floor critical Government control-centre fit out, complete with offices, within a high-end commercial building in Perth.
- › The brief for this 4000 square meter project was to create a modern flexible, collaborative and secure workplace for critical Government service departments to be housed together and to share common resources.
- › Base-building power services must be secured with layers of backup to ensure the continuation of critical services, especially during times of State emergency.
- › Cablewise worked seamlessly with the Shape team to ensure the smooth installation of a rooftop generator, to back up critical communications servers and a major upgrade replacement of the basebuild power generator, to increase capacity.
- › Multiple electric vehicle chargers were required to progress the Governments transition to electric worker pool vehicles.





“ The onsite Cablewise Electrical project team worked seamlessly with the Shape team to ensure the smooth installation of a rooftop generator, to back up critical communications servers and a major upgrade replacement of the basebuild power generator, to increase capacity.

As part of the project solution, Cablewise Electrical also assessed and upgraded the power infrastructure to facilitate the addition of multiple EV chargers.

The entirety of the project was completed to the highest standards without interrupting other commercial tenants in any way through careful planning and communication.

Andrew Asher - Site Lead

TECHNICAL SERVICES

- › Provision of a Siemon Cat6A F/UTP structured cabling solution with Consolidation Points.
- › Full Clevertronics HIVE Emergency Escape Lighting solution was implemented, complete with new head-end and monitoring software.
- › Supply and installation of a new 800kVA and 350kVA Generator Sets in the basement and rooftop, inclusive of delivery and positioning.
- › Philips Dynalite Dali Intelligent lighting control including Daylight Harvesting, installed and programmed by our internal Cablewise Integrated Services team.
- › Detailed feature lighting installed throughout.
- › A complete Schneider Electric EV Charging solution for Government vehicles, installed and programmed by our internal Cablewise Integrated Services team.

Case Study

Shape Group

William Square Office Fit-out
William Street, Northbridge



Year



Under \$2M



6000 SQM

Detail of Works Completed under Contract or Agreement:

COMMERCIAL FACTORS

- › William Square is centrally located in the northern precinct of Perth's CBD on William Street, in close proximity to all major transport hubs.
- › Purpose built for the Commonwealth Government in 1992, Cablewise were engaged to complete a major full building Electrical, Communications, and Intelligent Lighting Solution upgrade as part of the major refurbishment.
- › The brief for this 6000 square meter project was to create a modern flexible, collaborative and secure workplace for critical Government service departments to be housed together and to share common resources.
- › The project consisted of a 2 year staged installation, completely revamping the dated building into a state of the art landmark in Northbridge.





“ **The Cablewise team delivered a fantastic project for us here at William Square. They listened carefully to our needs, understood the details and exceeded expectations. We are extremely happy with the final outcome in what is arguably now one of Perth's best and technologically advanced buildings, fitted out with a high security communications infrastructure and most advance lighting control system.**

Rob Weise - Blackoak Property

TECHNICAL SERVICES

- › Provision of a Commscope Cat6A UTP structured cabling solution.
- › New monitored Emergency Escape Lighting solution, complete with new head-end and monitoring software.
- › Supply and installation of a new 250kVA and 350kVA Generator Sets in the basement and ground floor, inclusive of delivery and positioning.
- › Philips Dynalite Dali Intelligent lighting control including Daylight Harvesting, installed and programmed by our internal Cablewise Integrated Services team.
- › Detailed feature lighting installed throughout.
- › Liaison with the ATO and CCC Government Departments for identification and implementation of their security network and deliverables.
- › Installation of specific colour coded cable basket throughout to easily identify electrical and communications services for safety.



Delivery | High Quality | Strong Relationships

